

ESI

**ASBESTOS HAZARD EMERGENCY RESPONSE ACT
(AHERA)
THREE-YEAR REINSPECTION REPORT**

GOLF MIDDLE SCHOOL

**9401 WAUKEGAN ROAD
MORTON GROVE, ILLINOIS
SCHOOL I.D. #14-016-0670-1002**

PREPARED FOR

**MR. TONY CANTORE
GOLF ELEMENTARY SCHOOL DISTRICT #67
9401 WAUKEGAN ROAD
MORTON GROVE, ILLINOIS**

OCTOBER 2021

TABLE OF CONTENTS

	<u>Page</u>
1. Introduction	2
2. Abated Homogeneous Areas	2
3. Remaining Homogeneous Areas	2
4. Additional Areas	3
5. Summary	3
6. Response Action and Cleaning Recommendations	3
7. Signature Page	4

1. INTRODUCTION

On 06 October 2021, the required Asbestos Hazard Emergency Response Act (AHERA) three-year reinspection of asbestos-containing materials was performed at Golf Middle School, 9401 Waukegan Road located in Morton Grove, Illinois. The reinspection was conducted by Nick Malone (IDPH Building Inspector #100-00182) of **ENVIRONMENTAL SERVICES, INC.** under the direction of Mr. Tony Cantore of Golf Elementary School District #67.

2. ABATED HOMOGENEOUS AREAS

Abated homogeneous areas refer to asbestos-containing materials that have been removed from the school since the December 2018 three-year reinspection.

Operations and Maintenance activities have not been reported in this section.

None

3. REMAINING HOMOGENEOUS AREAS

Remaining homogeneous areas refers to identified asbestos-containing materials of similar appearance that still exist in the school facility. These materials have been identified in previous inspections and reinspections and have been documented in the management plan. The results of the reinspection are listed according to their homogeneous areas. Refer to the building flooring plan for remaining and abated flooring / flooring mastic.

AREA #	TYPE OF ACBM
P-3:	Above ceilings and in wall pipe insulation
P-7:	Cementitious Pipe Fittings, roof drains - Building 1969
F-1:	12" x 12" or 9" x 9" Floor Tile and Mastic - Building 1963
M-1:	Unit-vents, wire insulation - suspect
M-7:	Kiln Fire Brick, Art Room - Building 1961 - removed
FD-6:	Metal Safe Door Northeast Office - Building 1961 - suspect
F-5:	Drywall and Tape compound throughout - suspect
FD-1:	Fire Doors - Building 1969 - suspect

3. REMAINING HOMOGENEOUS AREAS (continued)

F-4A: Black Mastic under 12" x 12" floor tile - Building 1969 - Corridor areas abated Summer Break 2015 - Replaced with non-ACM vinyl plank adhesive. Other areas remain in good to fair condition.

F-4: 12" x 12" Floor Tile - Building 1969 - Corridor areas abated Summer Break 2015 - Replaced with non-ACM vinyl plank adhesive. Other areas remain in good to fair condition.

4. ADDITIONAL AREAS

Additional areas include suspect asbestos-containing building materials identified during this reinspection which were not included in the original management plan or subsequent three-year reinspections.

5. SUMMARY

During this reinspection, it was noted that asbestos-containing materials within Hynes Elementary School are maintained in good condition.

6. RESPONSE ACTION AND CLEANING RECOMMENDATIONS

Continue to monitor asbestos-containing building materials in the building for any changes in condition. If renovation or demolition is planned that will disturb suspect asbestos-containing materials, it will be necessary to collect and analyze samples from these materials for the presence of asbestos.

No changes in the cleaning requirements, methods or frequency are recommended at this time. The additional area should be tested to determine whether the material is asbestos-containing material or added to the management plan as a suspect building material. The management plan should be amended to include the additional areas identified. The additional areas should be included in the management plan budget for Operations and Maintenance.

7. SIGNATURE PAGE

The three-year reinspection of Golf Middle School has been completed in substantive compliance with current AHERA guidelines.

Nick Malone



Nick Malone, Inspector
IDPH License #100-00182

The three-year reinspection of Golf Middle School has been completed in substantive compliance with current AHERA guidelines and Illinois Department of Public Health guidelines. The Management Plan should be amended to include the Additional Homogeneous Areas. The Management Plan budget should be adjusted to include Periodic Surveillance and Operations and Maintenance of these building materials.

Nick Malone

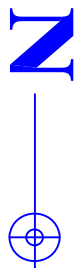
Nick Malone, Management Planner
IDPH License #100-00182



 ACM FT/MAS
 ACM FT/MAS UNDER CARPET

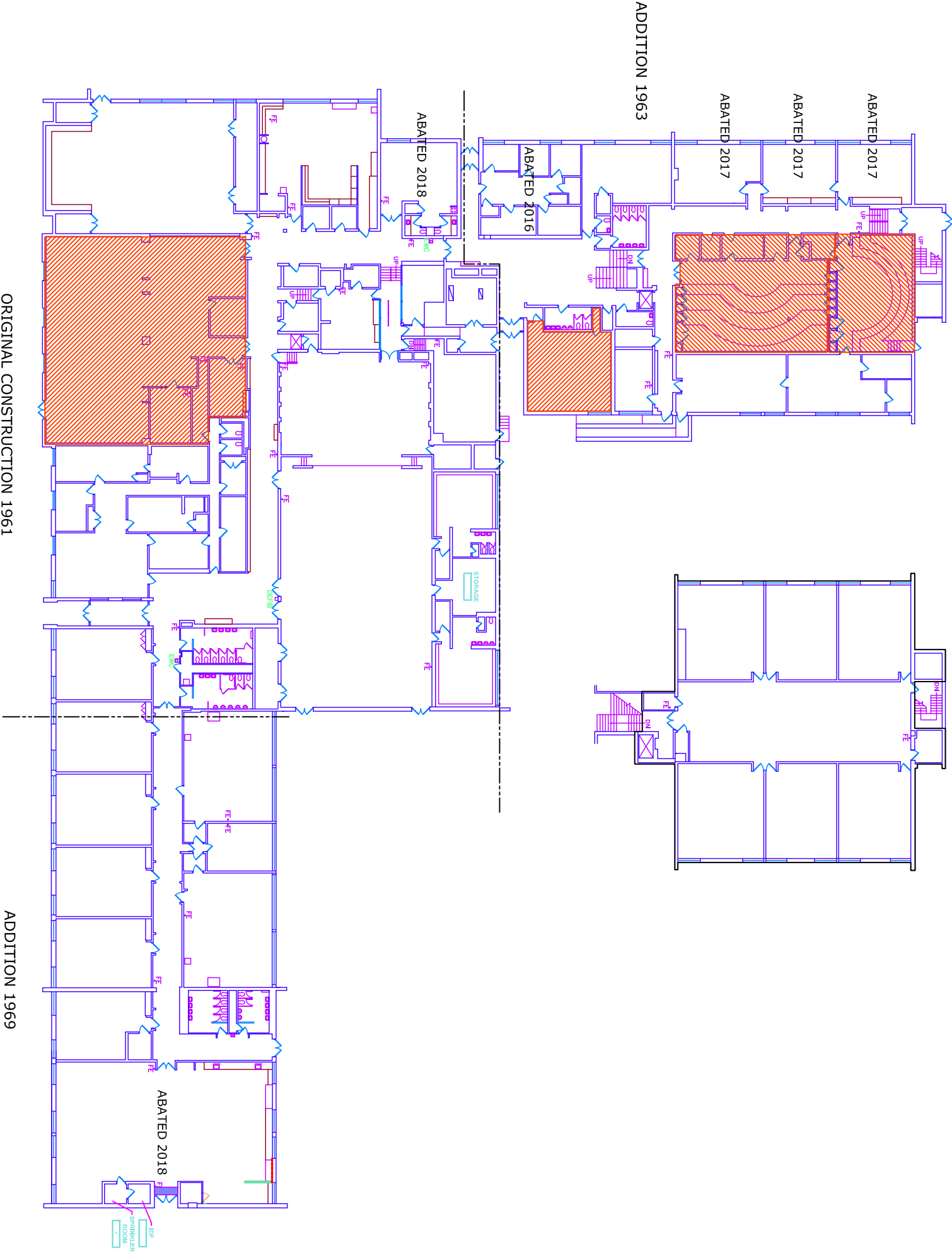

ESI CHICAGO, INC.

P.O. BOX 303
 LA GRANGE, IL 60525-0303
 708 354 7121
 WWW.ESICHICAGO.COM

SHEET 1 OF 1	PROJECT 5457 FILE GMSacmFloors	DATE 06 Oct 2021 SCALE NONE	GOLF MIDDLE SCHOOL AHERA REINSPECTION ACM FLOORING UPDATE	GOLF SCHOOL DISTRICT #67 9401 WAUKEGAN ROAD MORTON GROVE, IL 60053
-----------------------	---	--------------------------------------	---	---